



SAME DEUTZ-FAHR



DEUTZ-FAHR 6040 pre-series

TECHNICAL SPECIFICATIONS

| 6040 | REQUIREMENT SPECIFICATION |
|--|---|
| FUNCTIONAL GROUP | DESCRIPTION |
| Front axle | Axle body welded like 4060 H 19 ton gearbox Side gears from 4060/Ectron |
| Rear axle | Rigid axle 6060 - one cylinder and servostat |
| Feeder channel | One part like Ectron without Adapter and w/ Pendel |
| Cabin | Adaptation of Commander II With driver platform floor cut Electric costs in driver platform |
| Engine | TCD 2012 L06 COMIII 163,9kW/222 BHP Water-cooled |
| Threshing syst. clutch Feeder chan. clutch Grain tank clutch | Mechanic lever in the cabin |
| Machine frame | Base platform - 56 series Weight saving Axle support like 4060 Supports on front axle like 56 series |
| Preparation floor with one part sieve box | Sieve box setup - one part Stepped floor non re-insertable |
| Short strawhood | Shortened version of 4060 strawhood |
| Strawwalkers | Short strawwalker from Globus |
| Concave regulation | Mechanical layout like 40 series outside of the cab (with Commander II simple solution) |
| Grain tank | One part welding construction |
| Drives | Strawwalker drive Engine shaft Wind variation |



CUTTERBARS



- 3 grain header size available:
 1. 4,2 m
 2. 4,8 m
 3. 5,4 m
- Header in farmline configuration:
without multicoupling and
without lateral float control
- Maximum corn header available:
6 rows flip-up with stalk chopper
- Maximum vario header available
4,85m
- Additional equipments:
 1. Sunflower attachment
 2. Oil seed rape extension

FEEDER CHANNEL



- One part construction, without pendel
- On bottom shaft with round supporting discs for chain, no sprockets
- Single bar feeder chain
- 2 V-belt drive, 2HB as option for corn
- Inversion drive, electro – motor
- Engagement by mechanic clutch
- 2 lifting cylinders as standard
- 1 additional cylinder as option

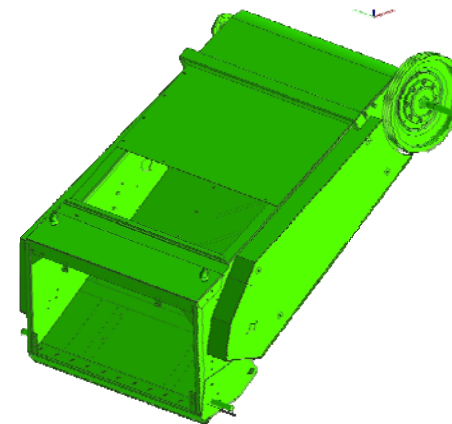

THRESHING SYSTEM

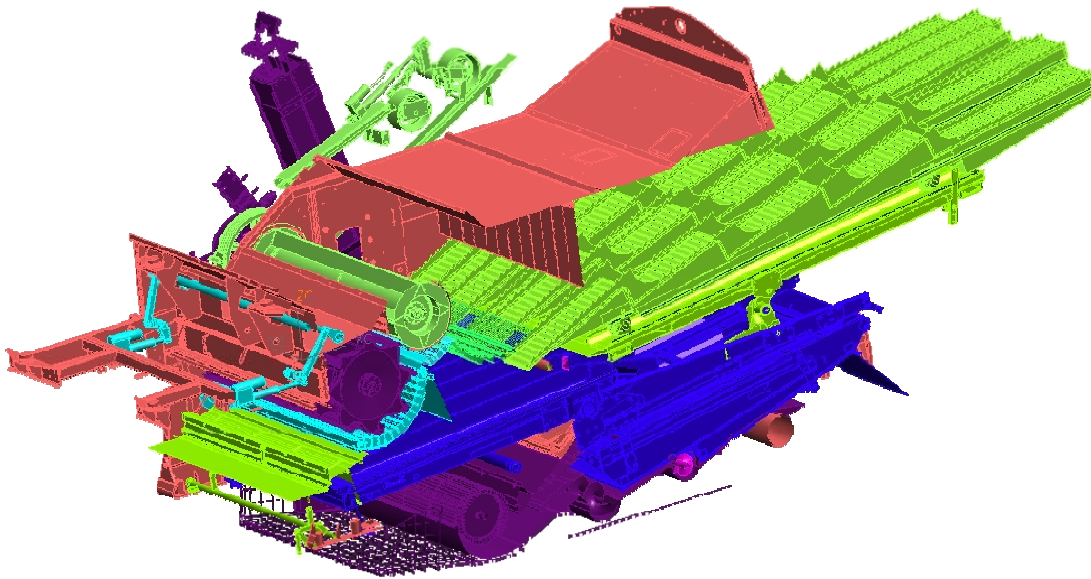

- Derived from 6060 w/o synchrobeater
- Shorter and closed version of strawwalkers, also wider for better performance
- Strawwalkers surface 5,28 m²
- One piece cleaning shoe, with external suspension and fixed stepped floor components (single acting)
- Sieves surface 4,22 m²
- Cross – flow fan from 6060
- All engagements and adjustments of the threshing system done manually by mechanic levers
- Threshing drum and fan speed with electrical adjustment
- Same threshing surface and geometry of the 6060 (**OPTIMUM DRESCHER**)
- Double return system to the grain pan with re-threshing units

CABIN

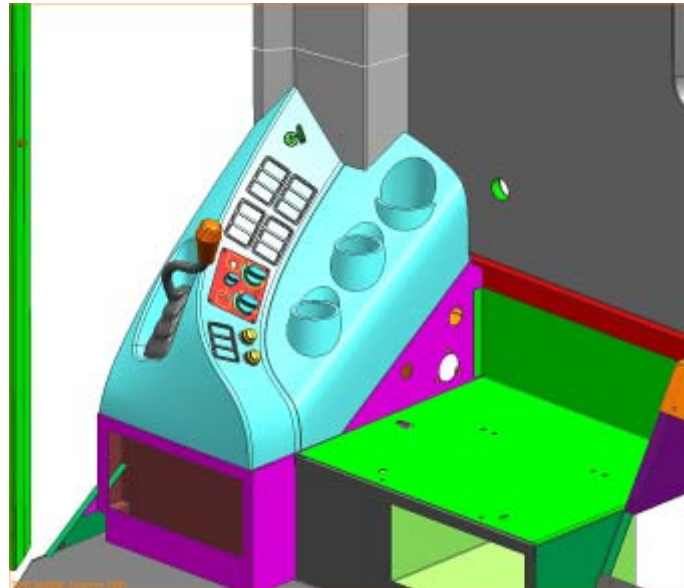

Commander Cab EVO:

- Derived from Commander Cab II but with a new styling:
1. New side console, with modern switches (derived from tractors)
 2. New interior with light gray trim
 3. New steering column
 4. New air conditioning package
 5. New CCM monitor (placed on the RH pillar)
 6. New lights from 60 series
 7. New electric system
 8. New Cab roof

FRAME AND STYLING

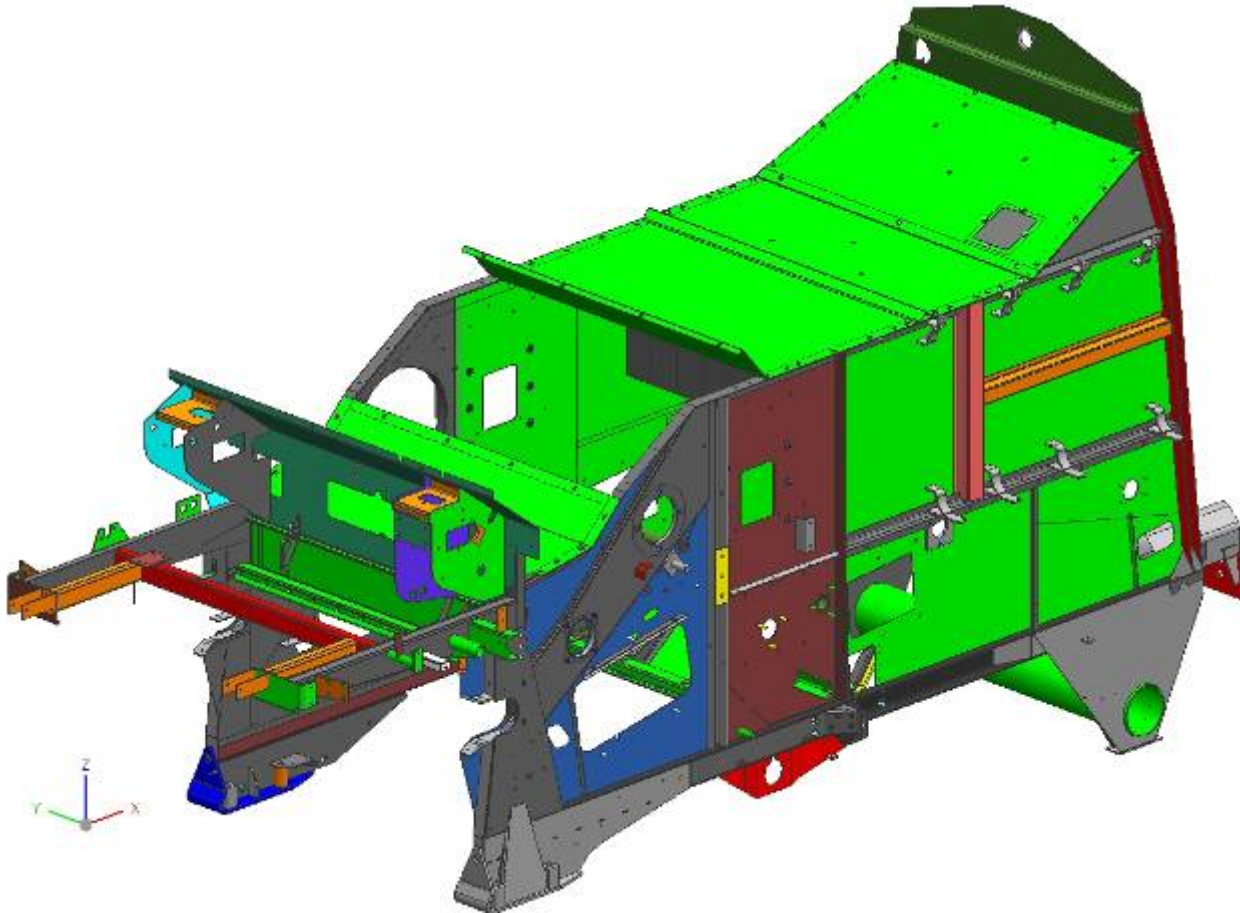

- Derived from 6060.
- Lighter version
- High capacity structure for an eco-combine
- Cab mounted directly on the driver platform
- Dark frame painting
- Shieldings:
 1. Horizontal hoods opening

GRAIN TANK

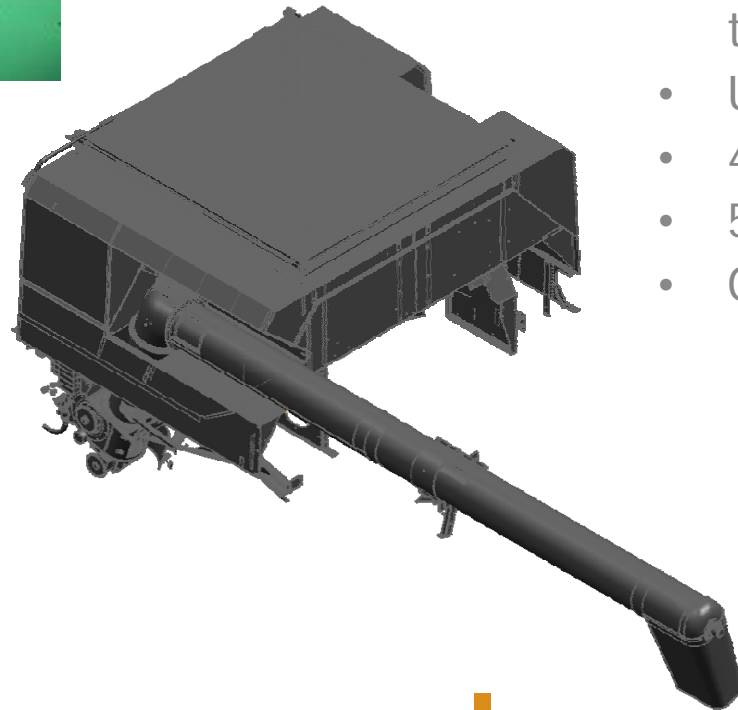

- Capacity: 6500 l
- Elevator from 6060
- Central loading auger
- Grain tank metal cover
- Grain tank unloading from the top
- Unloading capacity: 75 lt/sec
- 4 m unloading pipe std
- 5m unloading pipe opt
- Grain sample opening

ENGINE

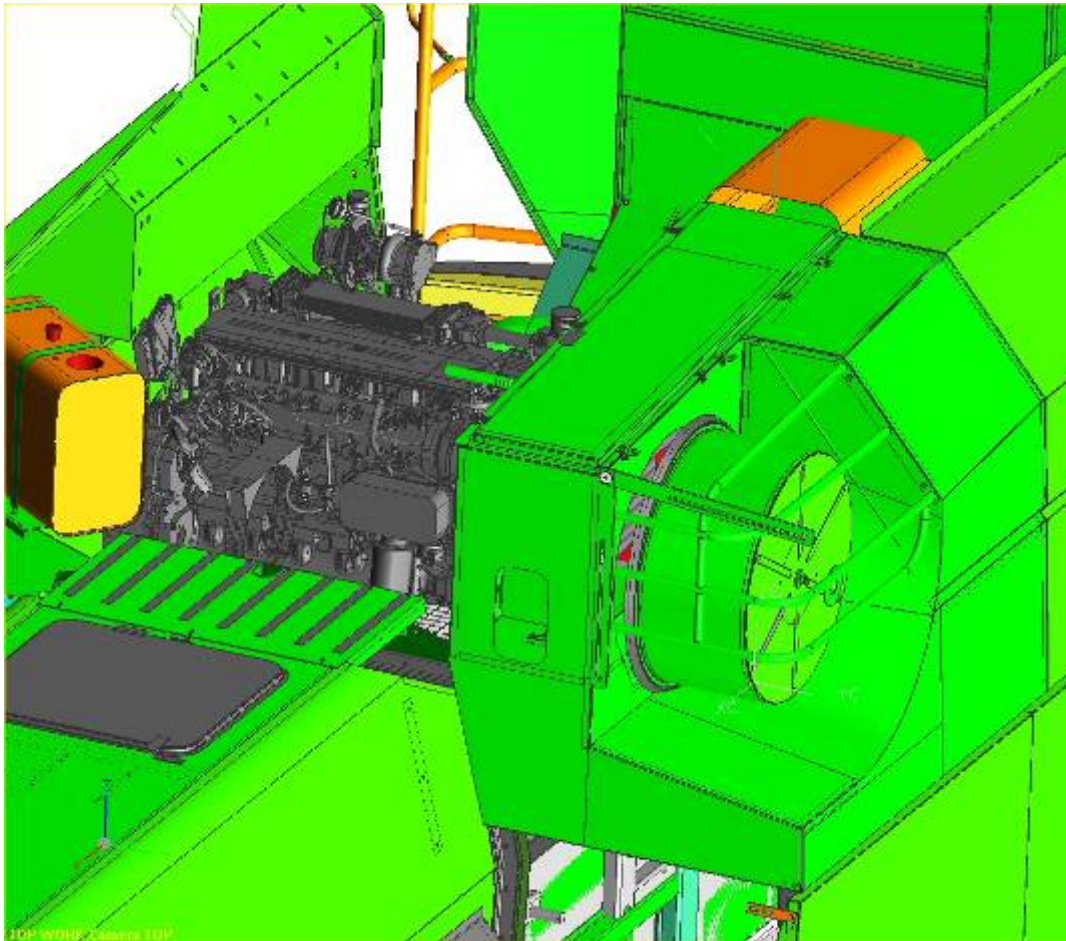

- TCD 2012 L06 4v
- 163,9 Kw/ 222 hp
- Common rail with double pump
- Internal EGR
- Electronic governor
- Double PTO
- 345 lt fuel tank std
- 450 lt fuel tank opt (from season 2011)

TRANSMISSION



TRANSMISSION

- Supplier: COBRA
- 19 ton capacity
- 75 cm³ Linde pump and motor
- Three speed gearbox
- Road speed 26 km/h max.
- Without differential lock

FINAL DRIVE

- Supplier: DANA
- 16 ton side gears
- 8 – wheel bolt M20x1.5
- Maximum dimensions of front tyres: 800/70 R32

FRONT AXLE

- Rigid body construction
- Quadratic profile welded components

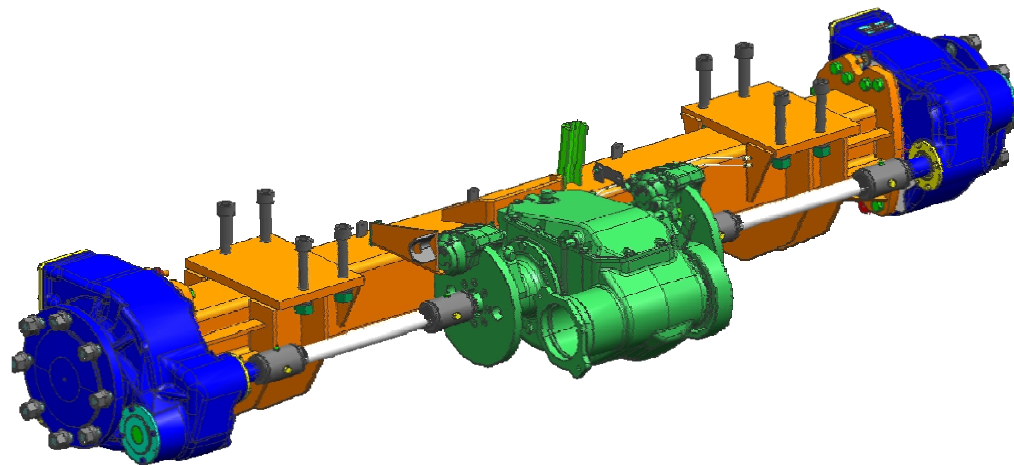

HYDRAULIC SYSTEM



- Steering: Seperate, open center hydraulic circuit
- Working hydraulics:
 - Bosch triple gear pump
- No hydraulic quick coupling but a manual solution
- Hydraulic block, with cutting height control from 56 series
- Manual engagement of the functions in case of electric failure
- Oil tank capacity 44 lt

TYRES AVAILABILITY

| Front Wheels | Width (mm) |
|------------------------|------------|
| 620/75 R30 ET42 MCHLN | 2997 |
| 650/75 R32 ET-30 CONTI | 3187 |
| 800/65 R32 ET-25 GY | 3263 |

| Rear Wheels | Notes |
|------------------------|-------|
| 320/80-18 (12.5/80-18) | STD |
| 405/70 R20 ET-45 | OPT |